

Future-Proofing Your Headquarters

In today's rapidly evolving workplace, a headquarters must be more than just a beautiful space—it must be a strategic asset that enhances collaboration, attracts top talent, and maximizes performance.

At DBSI, we go beyond aesthetics, leveraging cutting-edge research, workplace trends, and our proprietary **FAQtor7** methodology to design headquarters that aren't just built for today—but equipped for a prosperous future.



The New Standard for Workplace Performance

The workplace is evolving, and outdated office layouts no longer meet employee expectations. Gartner research shows that organizations embracing human-centric design—flexibility, intentional collaboration, and empathetic leadership—**can boost employee performance by up to 54%**.



FAQTOR7: DBSI's Data-Driven Tool

Eliminating the Guesswork

Through a comprehensive discovery process, DBSI experts analyze employee behaviors, department growth trajectories, and emerging workplace trends. With **FAQtor7**, your headquarters isn't just built for today—it's designed to support your organization's future growth for many years to come.

Most headquarters designs focus on immediate needs rather than long-term scalability. **FAQtor7** changes that by using real data to answer critical questions:

- How do we design for hybrid work?
- What balance of collaborative vs. private workspaces will maximize productivity?
- What adjacencies will improve workflow and efficiency?
- How do we create a space that attracts and retains top talent?
- What space allocations should we plan for 3, 5, and 10 years down the road?



High-Performing Headquarters That Inspire

GECU

40,000 SF HQ + 80,000 SF Ops Expansion

GECU wasn't just outgrowing its space—it was evolving. With significant investments in digital banking and in-branch technology, they needed a headquarters that could keep pace with innovation while providing the infrastructure to support long-term growth. For a future-proof solution, they turned to their trusted design-build partner, DBSI.

- »»» Integrated real estate acquisition, digital signage, and branch expansion
- »»» **80% adoption rate** of banking technology, improving member engagement
- »»» Phased master plan delivering high-impact, future-proof growth



DBSI applied **FAQtor7** to determine the ideal mix of open and private spaces, strategic adjacencies for improved workflow, and design elements that elevate employee experience and workplace culture.

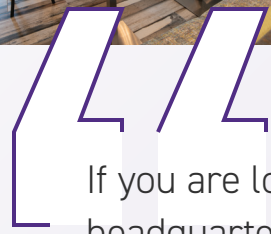

If you are looking to DBSI for your headquarters project, know you are in good hands. We don't say it lightly, DBSI truly is a firm you can firmly believe in!

Kinective

Tenant Improvement +
Flagship HQ Design 25,000 SF

To create a standout, cohesive headquarters experience, Kinective needed a space that embodied its forward-thinking approach while supporting a hybrid work model, enhancing productivity, and fostering employee well-being.

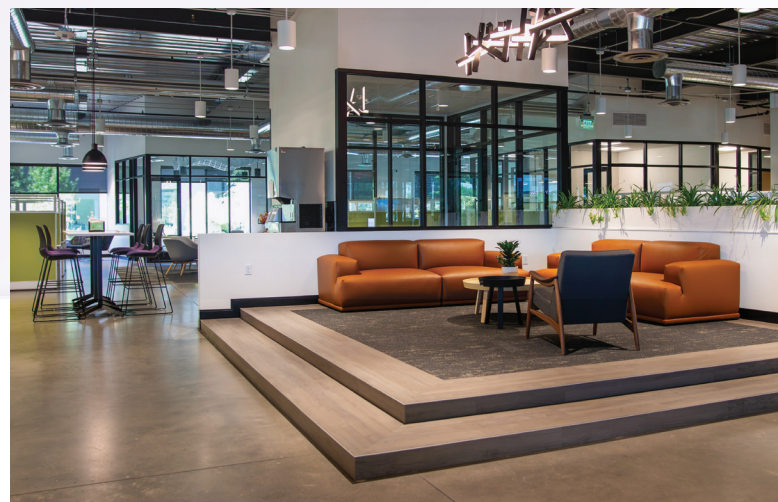

DBSI strategically designed Kinective's high-performing headquarters featuring:



Flexible Workspaces

A dynamic environment with hoteling stations, modular furniture, and multipurpose areas, ensuring adaptability for hybrid teams.



Purposeful Collaboration Zones

Thoughtfully positioned spaces that encourage employee engagement, teamwork, and innovation while maintaining areas for focused work.



Employee-Centric Amenities

Wellness rooms, outdoor workspaces, and premium-grade kitchen amenities designed to enhance workplace satisfaction, retention, and overall employee experience.



The result? A fintech HQ that maximizes functionality, comfort, and culture—allowing Kinective to thrive today and scale for the future.

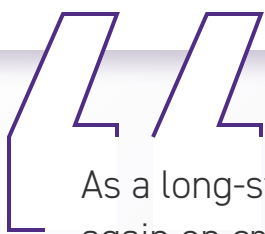

As a long-standing partner of DBSI, we were ecstatic to collaborate with them again on creating our headquarters space. Their ability to take our suggestions and input while bringing our vision to life is remarkable, a true testament to how talented their team is.

Engaging Employees Through All The Senses

In-Person Team Building

Hybrid work environments thrive when in-person and virtual collaboration is seamless. Imagine transforming your HQ's kitchen and patio area into a multi-purpose innovation hub for spontaneous brainstorming and team-building sessions.

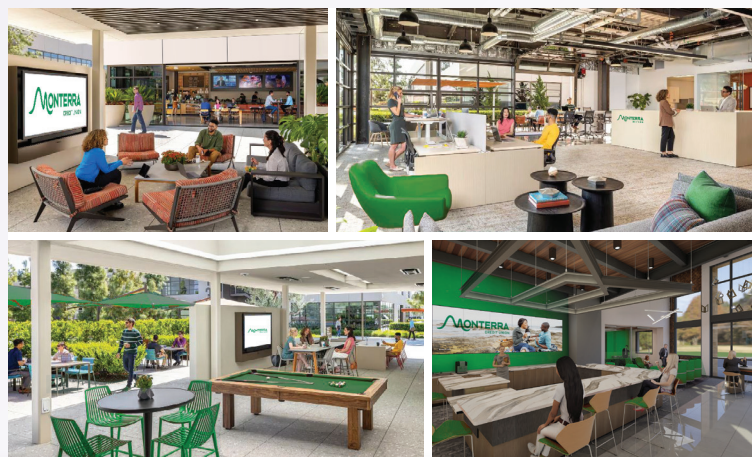

Digital Signage

Digital signage isn't just for branches—it's a HQ tool for:

- > Highlighting company milestones
- > Encouraging employee participation
- > Showcasing company values and achievements

Studies show employees are **75% more likely to watch a video than read text** (Celent), making digital signage a cost-effective, dynamic way to communicate.



Staff Amenities That Pay Off

Investing in employee-centric amenities delivers a measurable return. A 2-4% increase in employee performance can offset the costs of these workplace enhancements, boosting engagement and retention.



Contact Us Today

WWW.DBISI.COM | 1-855-ASK-DBSI | INFO@DBISI-INC.COM